

Porsche 914 Relay Board

Solid State Relays

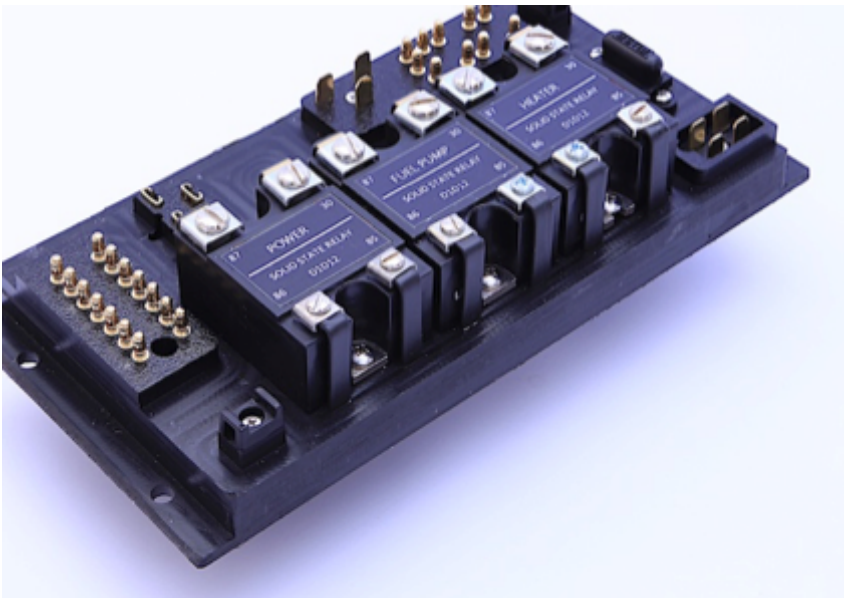

Electromagnetic Relays



- There are no provisions for a rear window heater.
- Uses ATC style fuse.
- LED illuminates when the relay board is supplying power to the fuel pump.

Electromagnetic Relay Board Layout

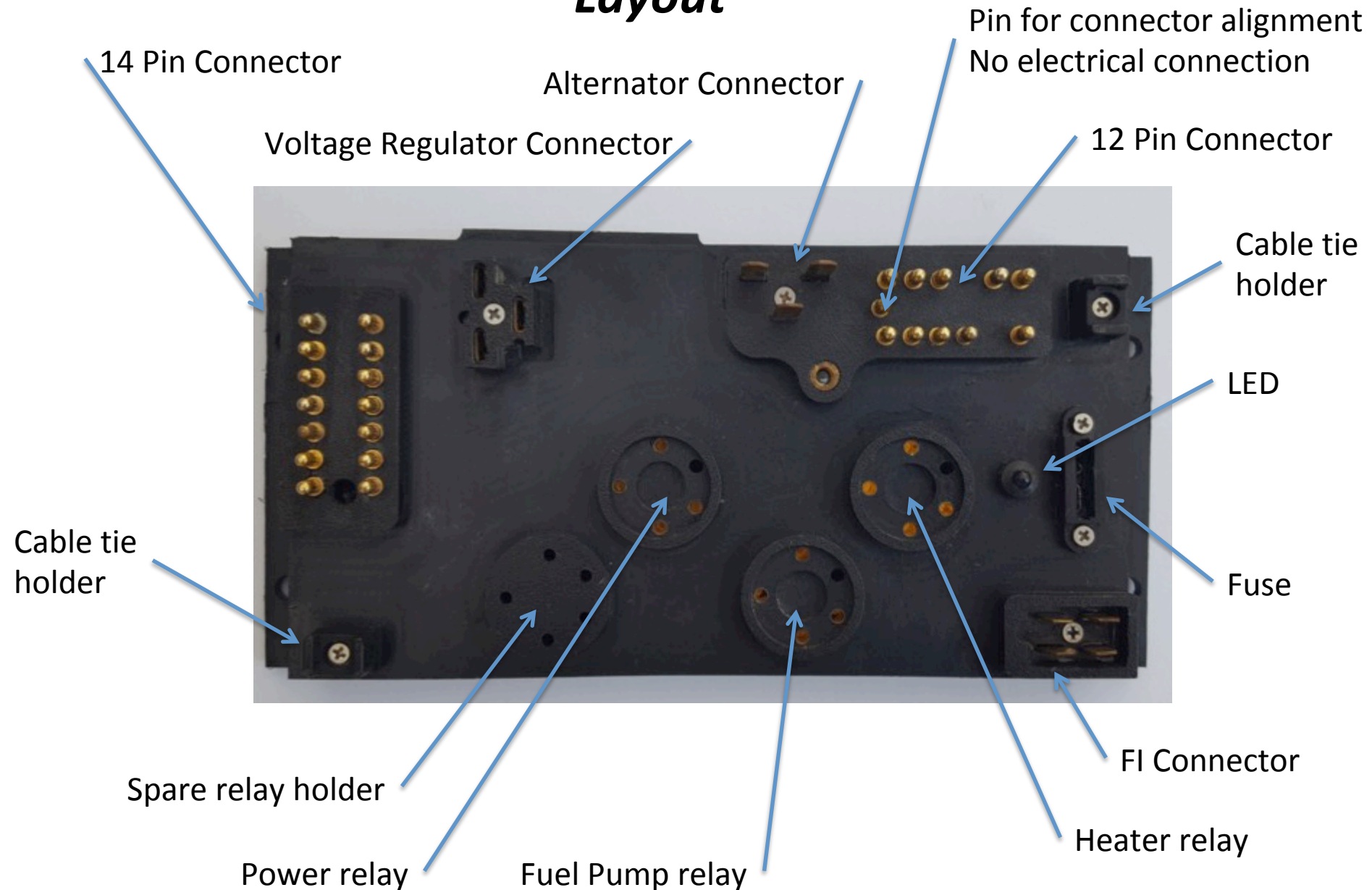

Solid State Relay Board Layout

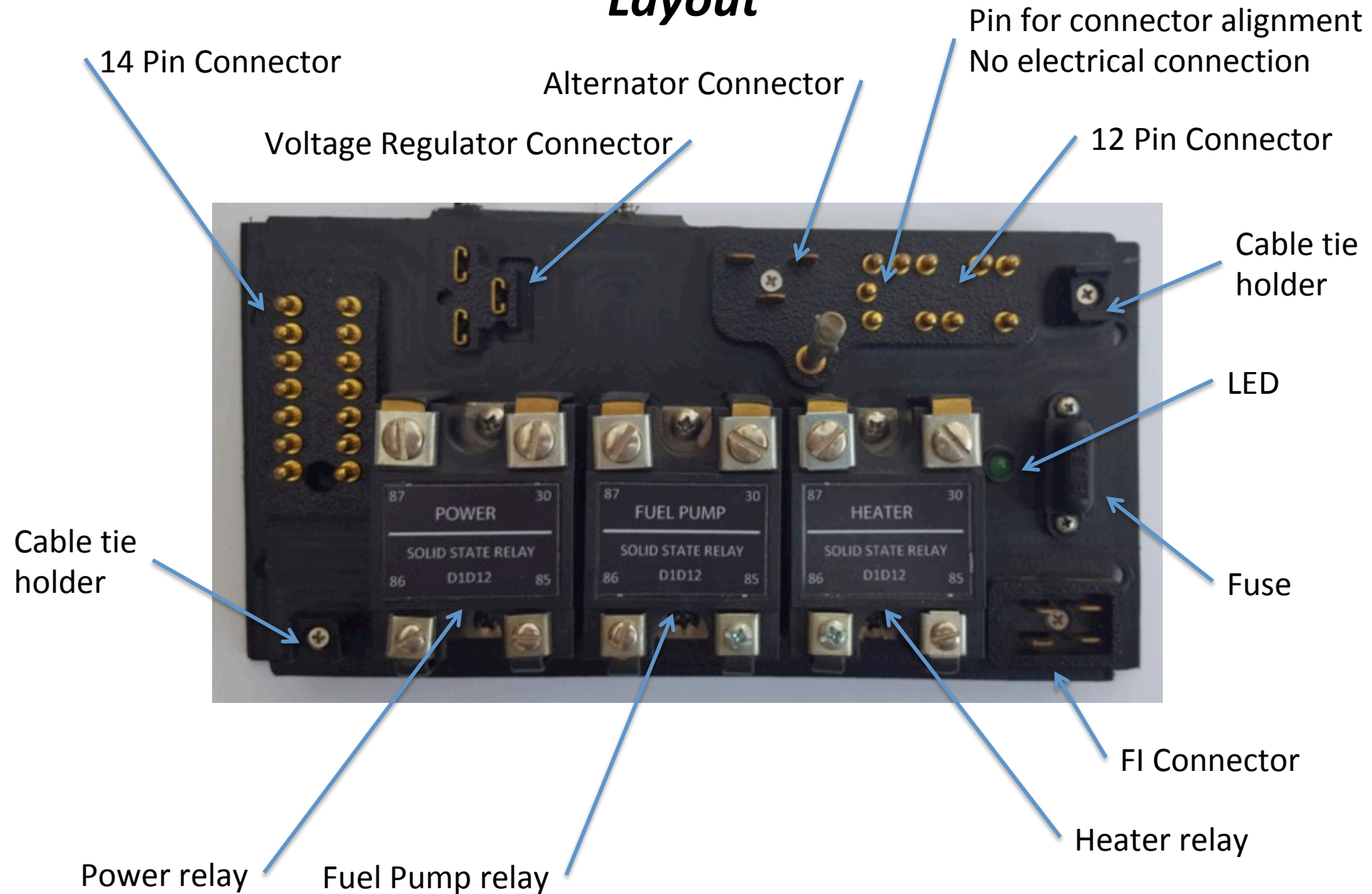

Porsche 914 Relay Board 3D Models

Solid State Relays

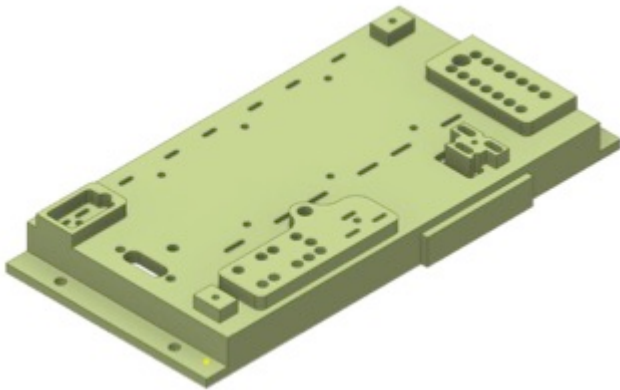

Electromagnetic Relays

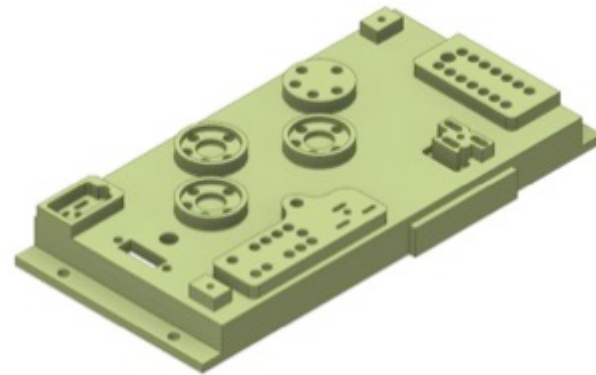

Alternator Plug Retainer



Voltage Regulator Boss



- 3D models are in STEP format.
- Hole sizes in the 3D model are for location only.

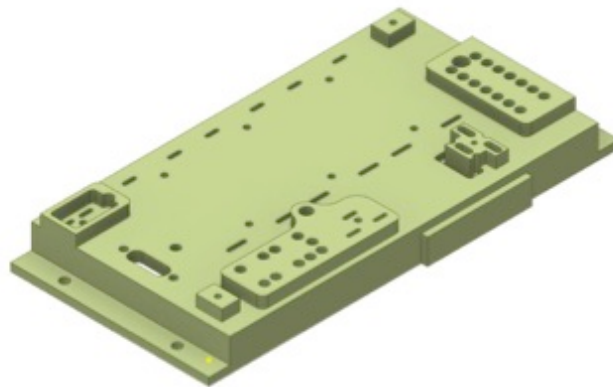

Solid State Relays

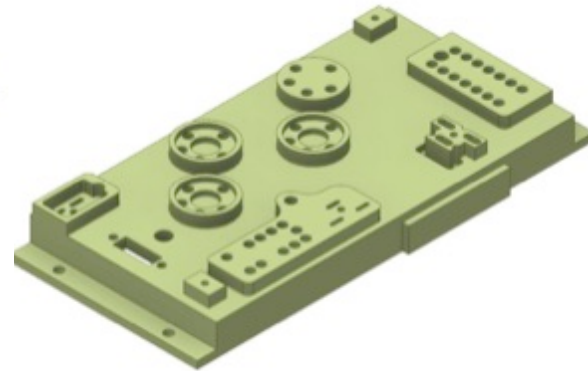

Electromagnetic Relays

914 Relay Board Parts Source

| Part | Description | Source |
|-----------------------------------|--|--------------------------------|
| Board Plastic | King Starboard HDPE polymer 1" thick | Plastic store, ebay or Amazon |
| Fuse Holder | Flush mount ATC Fuse holder ¼" thick | Ebay |
| Fuse | 15A ATC Fuse | Auto parts store, Amazon, ebay |
| Wire | 14 & 16 AWG wire | Auto parts store, Amazon, ebay |
| 14 & 12 Pin connector pins | 3.5mm bullet connector Banana plug (Male only) | Ebay, Amazon |
| Voltage Regulator Plugs | Supco T11121 | Auto parts store, Amazon, ebay |
| Solid State Relay | Crydom D1D12 | Digi-Key, Mouser, Amazon |
| LED | 12V Panel mount LED | ebay |
| Threaded insert for cover support | M5 threaded insert | ebay |
| Electromagnetic Relay socket | 3.0mm bullet connector Banana plug (Female only) | Ebay, Amazon |
| Epoxy Sealer | EpoxySeal 9000 | Amazon |

914 Relay Board Parts Source



100pcs 5mm HC-1 Nylon Cable Tie Holder Saddle Shape Mount Wire Holder K9
★★★★★ Be the first to [write a review](#).

Condition: **New**

Quantity: More than 10 available
23 sold / [See feedback](#)

Price: **US \$2.58**

[Buy It Now](#)
[Add to cart](#)
[Add to Watchlist](#)

100% buyer satisfaction 23 sold 60-day returns

Shipping: **\$3.45** Standard SpeedPAK from



M4 M5 Press-in Brass Injection Molding Knurled Thread Insert Embedded Nuts

Condition: **New**

Size[Inner Dia. * Outer Dia.]:

Length:

Quantity[Piece]:

Quantity: 5 available / **8 sold**

Price: **US \$1.55**

[Buy It Now](#)
[Add to cart](#)
[Add to Watchlist](#)



2 PACK

2x Flush Mount ATC blade fuse holder - build you own fuse panel spade ends w/cap

Condition: **--**

Quantity: 9 available / **29 sold**

Price: **US \$10.98**

[Buy It Now](#)
[Add to cart](#)
[Add to Watchlist](#)

29 sold More than 75% sold Same day shipping

Shipping: **\$2.99** Expedited Shipping | See details
Item location: Millersport, Ohio, United States
Ships to: United States and many other countries | See details

SAME day SHIP from OHIO



F5mm 12V white Red Round Pre-wired water Clear led with Plastic Holder 10-100Pcs

Condition: **New**

Emitting Color:

Holder a:

working voltage:

Qty a:

Quantity: 9 available

Price: **US \$0.99**

[Buy It Now](#)
[Add to cart](#)
[Add to Watchlist](#)

Relay Board Fabrication

The board is CNC machined from 1" thick King starboard HDPE Polymer plastic. This plastic is available from most plastic suppliers or on Amazon and ebay. Two machining setups are required: one for the top and one for the bottom.

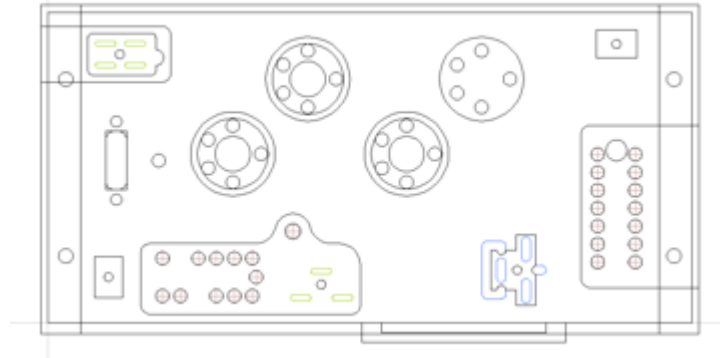
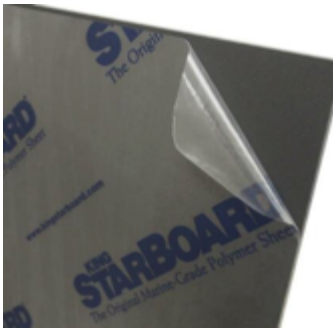

Milling Tools Required

- .250 2 flute end mill
- .125 2 flute end mill
- .0625 2 flute end mill
- 82 deg countersink V bit
- #13 Drill
- 1/8" Drill
- 3.5mm Drill
- 5/32" Drill
- 17/64" Drill
- 1/4" Drill

Relay Board Fabrication

Hole Size

The hole sizes in the 3D models do not reflect the actual final hole size.

The holes in the 3D model are for location only.

The hole size in the final part is determined by the drill bit used to make the hole.

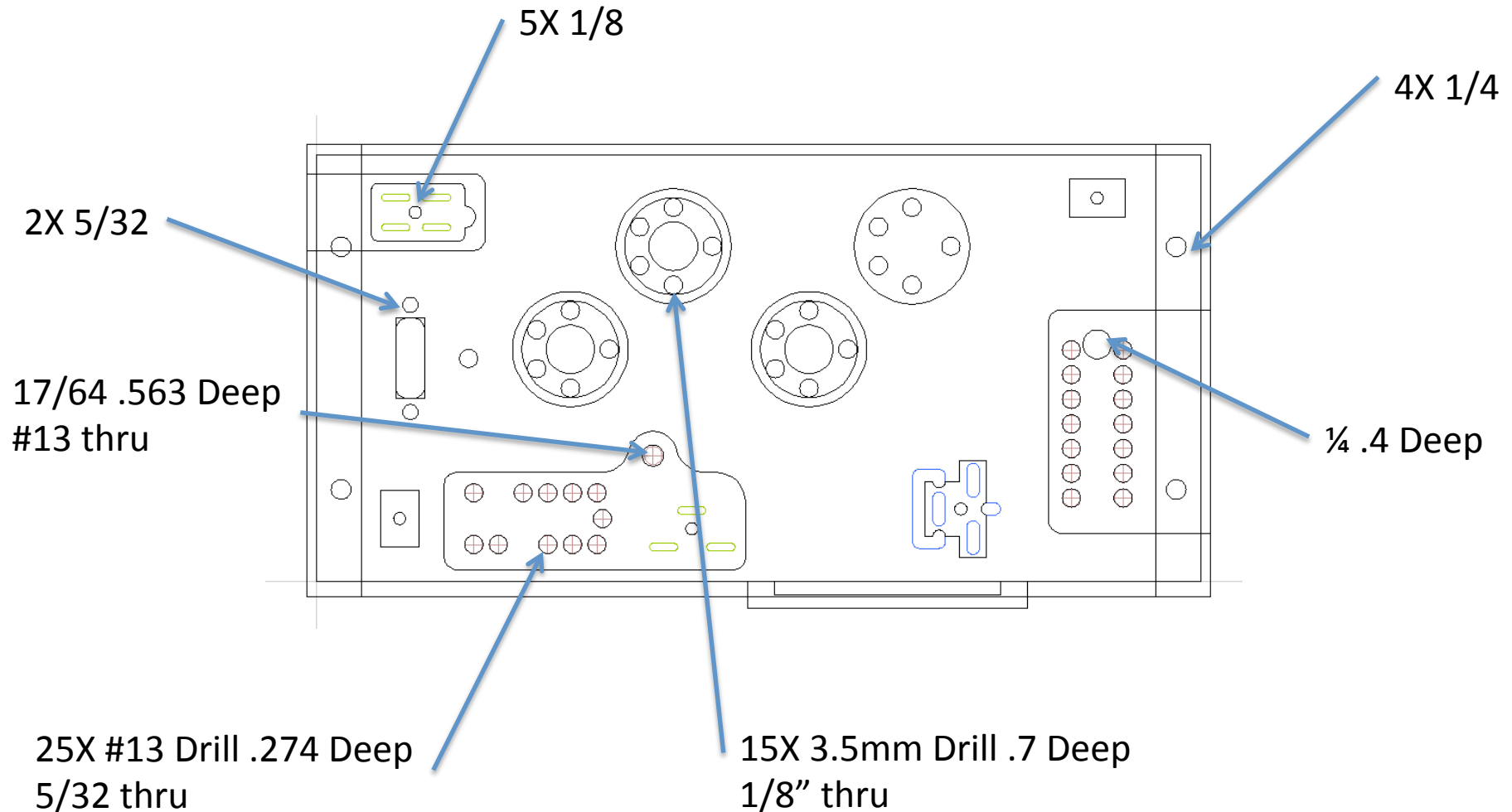

Alternator Plug



Make spade connectors from .031 X .25 brass sheet
Cover with heat shrink tubing

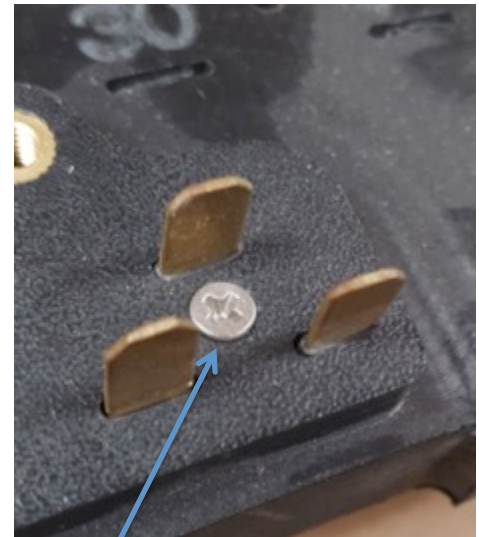
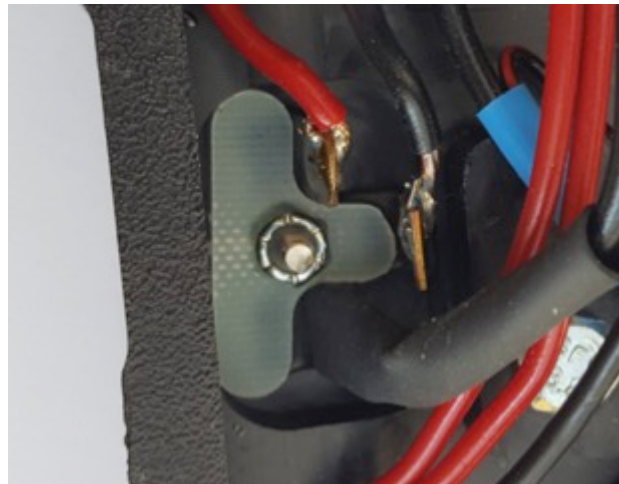
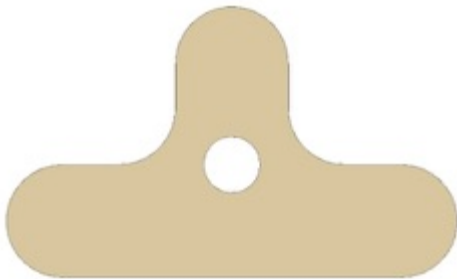

Machine from 1/16"
G10 fiberglass per 3D model

4-40 FHMS

Fuel Injector Plug



- Make spade connectors from .031 X .25 brass sheet
- Make spade connectors long and trim to length after installation
- Cover with heat shrink tubing



4-40 FHMS

Voltage Regulator Connector Base Fabrication

The voltage regulator connector base is CNC machined per the 3D model from ¼" thick King starboard HDPE Polymer plastic and attached to the relay board with a 4-40 flat head machine screw/nut.

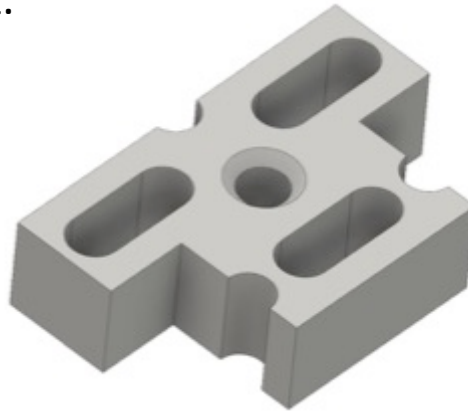
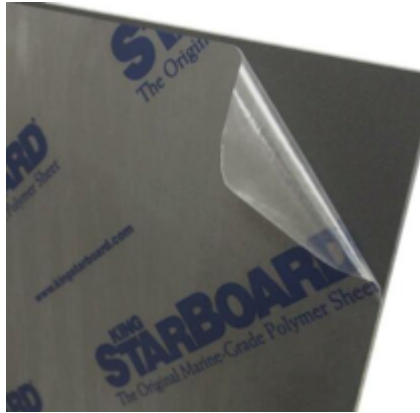

Milling Tools Required

- 1/8" Drill
- 1/8" End Mill
- 1/16" End Mill
- 82 deg countersink V bit

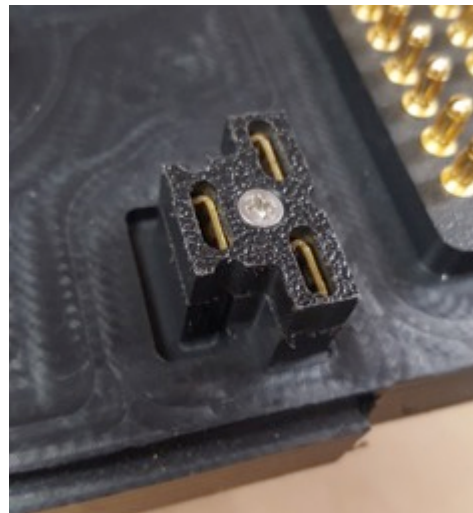

Voltage Regulator Plug

- Make spade connector from Supco T1121 terminal
- Install connector base onto relay board with 4-40 bolt/nut
- Insert spade connector and bend tab to retain the connector

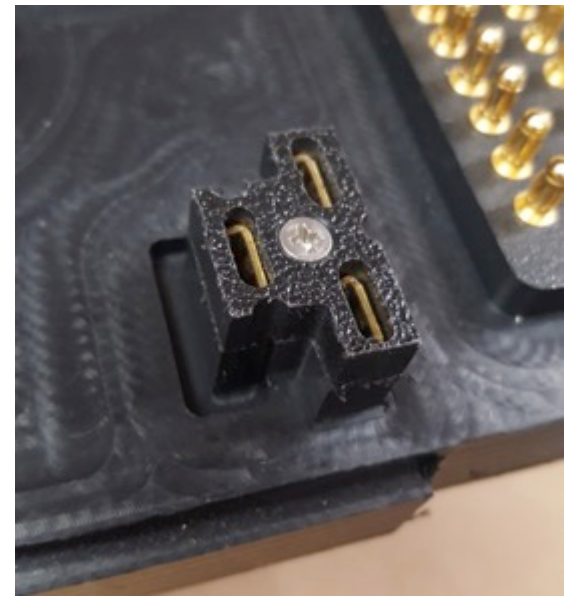

Supco T1121 Chair Terminal, 1/4" 2 Male and 1 Female Tabs (Pack of 10)

Brand: Supco

★★★★★ 84 ratings

Price: **\$11.29** & **FREE Shipping** on orders over \$25.00 shipped by Amazon. [Details](#) & [FREE Returns](#)

Available at a lower price from [other sellers](#) that may not offer free Prime shipping.
Returnable within 30 days of receipt

Size: **1/4" 2 Male and 1 Female Tabs**

1/4" 2 Male and 1 Female Tabs

12-10 Gauge, #10 Stud

16-14 Gauge, #10 Stud

Number of Items: **10**

[View image](#) [Zoom image](#)

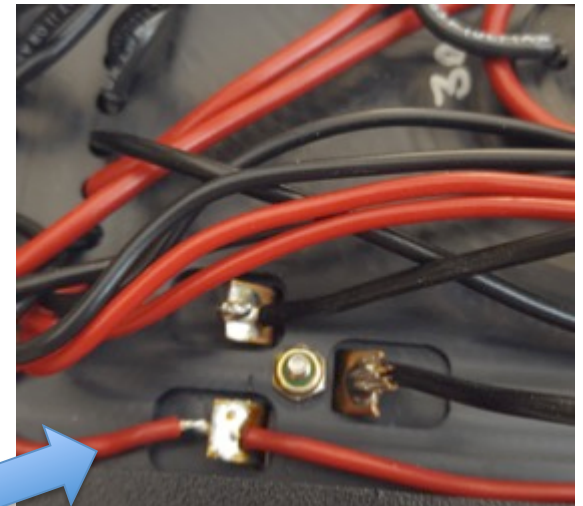

Make from T1121.
Remove tabs and bend flat



Spade connector

14 & 12 Pin Connector

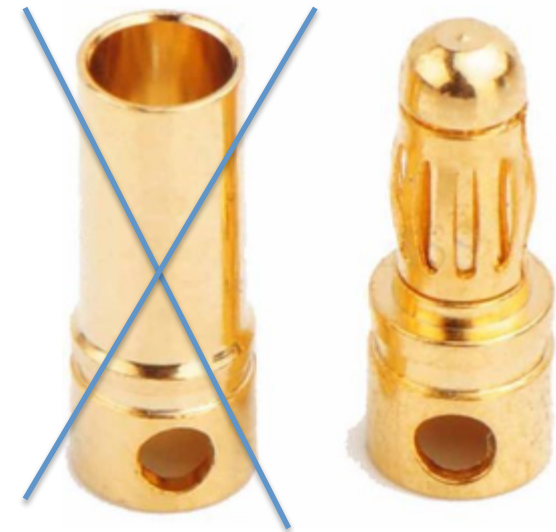
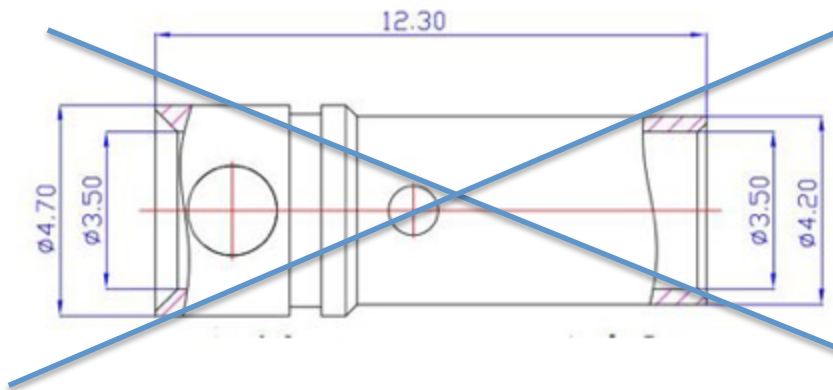
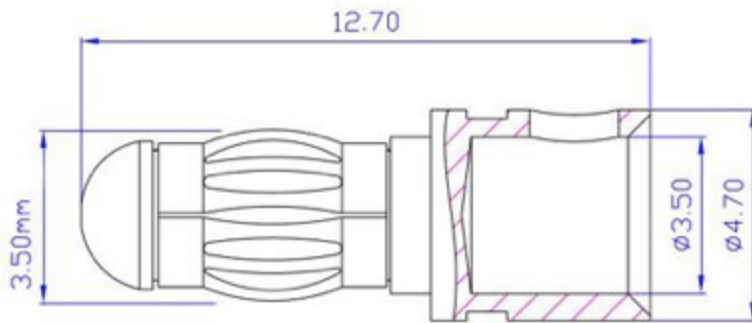

3.5mm Bullet Connector Gold Banana Plugs

These are available on ebay or Amazon.

Only the male pin is used.

Electromagnetic Relay Connector

3.0mm Bullet Connector Gold Banana Plugs

These are available on ebay or Amazon.

Only the female pin is used.



Relay Board Cover Support Rod Insert



M5 threaded insert

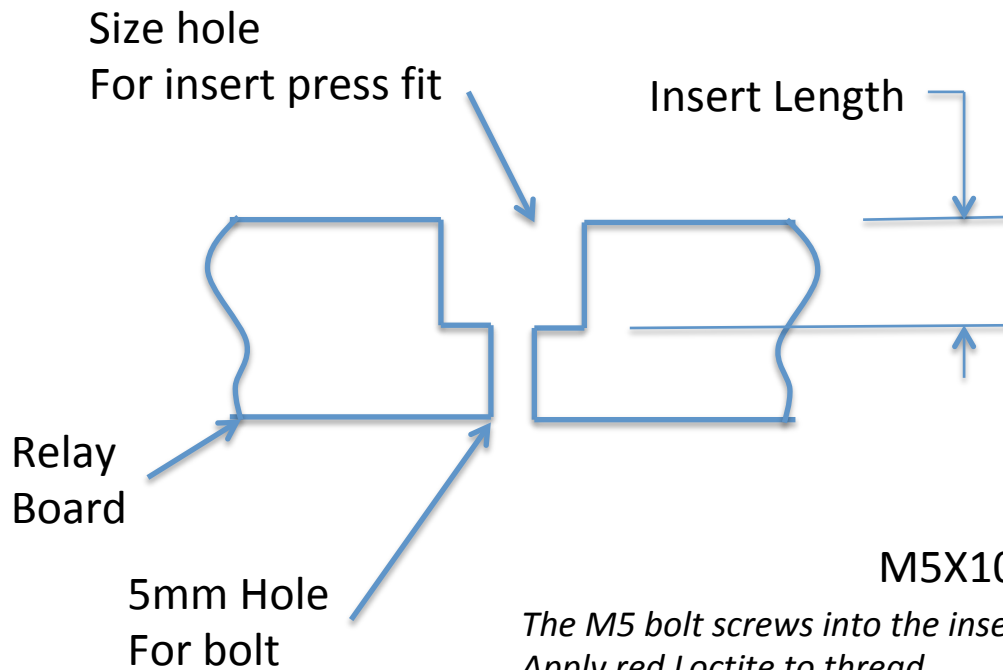

M5X10 bolt

*The M5 bolt screws into the insert preventing it from pulling out
Apply red Loctite to thread*

Wiring

Porsche 914 Relay Board Wire List

| Wire Size (AWG) | Connection No. | From | To | To | To |
|-----------------|----------------|-------------|-----------------|-----------------|-----------------|
| 10 | 1 | 14P_1 | 12P_6 | FI_Plug_II | FI_Plug_IV |
| 14 | 2 | 14P_2 | VR_D+ | ALT_D+ | |
| 14 | 3 | 14P_3 | 12P_2 | | |
| 14 | 4 | 14P_4 | 12P_4 | | |
| 14 | 5 | 14P_5 | 12P_1 | | |
| 14 | 6 | 14P_6 | 12P_3 | | |
| 14 | 7 | 14P_7 | 12P_5 | | |
| 18 | 8 | 14P_8 | 12P_7 | PWR_Relay_85 | Heater_Relay_85 |
| 18 | 9 | 14P_9 | Heater_Relay_86 | | |
| 18 | 10 | 14P_10 | PWR_Relay_86 | LED_Black | |
| 14 | 11 | 14P_11 | 12P_10 | 12P_11 | Heater_Relay_87 |
| 14 | 12 | 14P_12 | PWR_Relay_30 | | |
| 14 | 13 | 14P_13 | Fuel_Relay_87 | 12P_12 | LED_Red |
| 14 | 14 | 14P_14 | Fuse_1 | | |
| | | | | | |
| 14 | 15 | Fuse_2 | Fuel_Relay_30 | Heater_Relay_30 | |
| | | | | | |
| 18 | 16 | 12P_3 | Not used | | |
| | | | | | |
| | 17 | 12P_8 | Not used | | |
| | 18 | 12P_9 | Not used | | |
| | | | | | |
| | 19 | FI_Plug_I | Fuel_Relay_85 | PWR_Relay_87 | |
| | | | | | |
| 18 | 20 | FI_Plug_III | Fuel_Relay_86 | | |
| | | | | | |
| 14 | 21 | VR_DF | ALT_DF | | |
| 14 | 22 | VR_D- | ALT_D- | | |

| Stock Relay | SSR |
|-------------|-----|
| 30 | 2 |
| 85 | 3 |
| 86 | 4 |
| 87 | 1 |
| 87a | |

Wiring

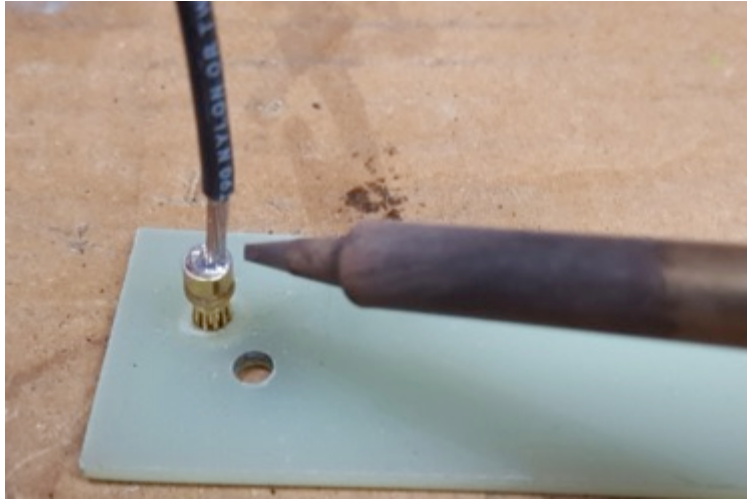

Solder wire to the 14 & 12 pin connector pins first



Insert the wire thru the hole and press in the pin



Solder on the relay connector



Press in the connector

Epoxy Potting Compound



Seal all connectors with
5 min epoxy and microballons



Fill with 5.25 oz Epoxyseal 9000
(3.5 oz part A and 1.75 oz part B)



Clamp to $\frac{1}{2}$ plywood with $\frac{1}{4}$ " Rubber
and release film (large zip lock bag)



Voltage Regulator

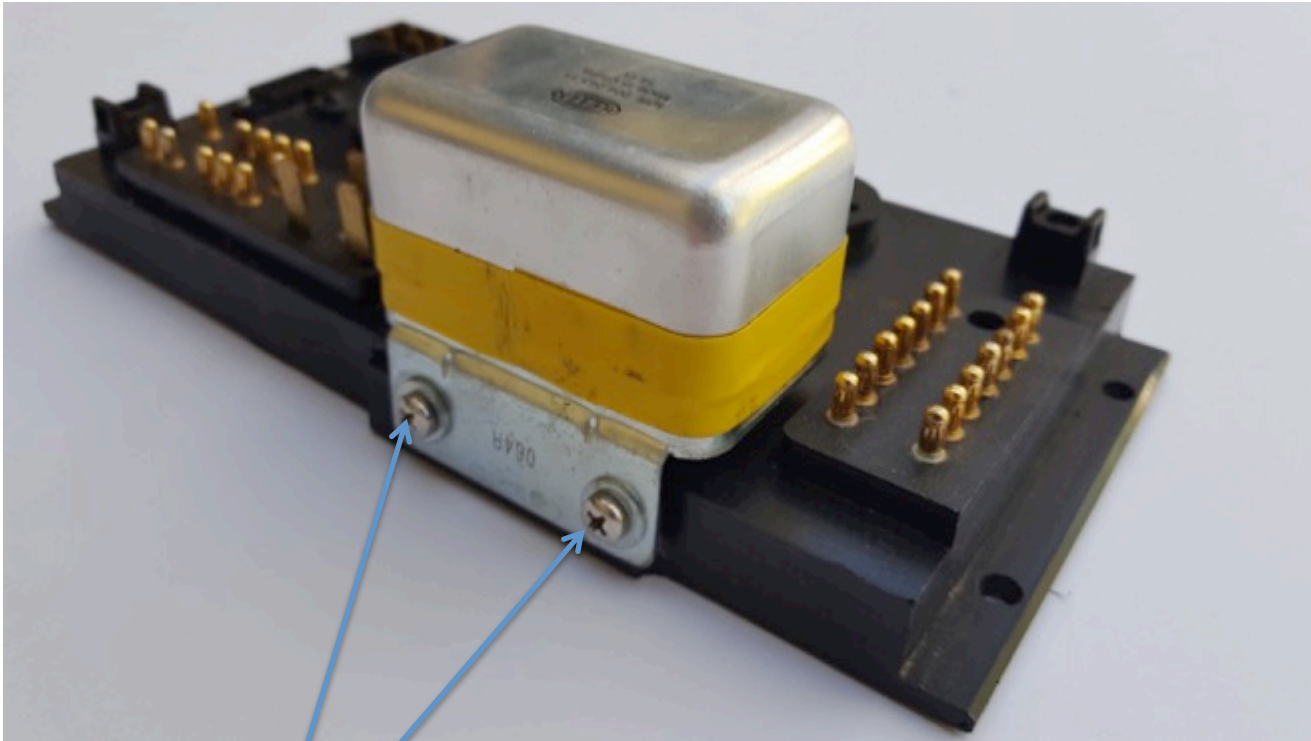

#8 Sheet metal screws .5 long with washer

Drill pilot holes .4 deep after applying Epoxyseal 9000

***Stock 914 Relay Board
(for reference)***



